



LAPIN G

GRAPHITE ELECTRODE HANDLING DEVICES



TORQUE WRENCH

Lapin torque wrenches have a proven quality due to reliable working at 4 continents over 100 Meltshops.

The best solution to prevent the future socket/nipple breaks and tip losses is using the correct tightening torque value. This value can change with usage of different electrode brands. After long years of experience, Lapin Torque Wrenches has been preset to best known average torque values for safety electrode handling. With our patented 4th generation torque wrenches, safe electrode tightening can be done up to 4700 Nm (Ø700 mm) with man power when needed.

Lapin suggests hydraulic/pneumatic tightening devices over electrode diameters Ø650HD/26".



Following standard models are available ;

Electrode Dia.(mm)	Order Nr.	Preset Torque Nm	B (mm)	C (mm)	Weight Kgs
250	TW250	550	850	1100	9
300	TW300	850	1030	1310	10
350	TW350	1050	1180	1485	11
400	TW400	1200	1310	1655	12
450	TW450	1500	1550	1930	17
500	TW500	2300	1800	2210	18,5
550	TW550	2900	1900	2340	20
600	TW600	3400	2020	2505	28
600	TW600HD	3800	2220	2710	33
650	TW650HD	4250	2700	3220	37
700	TW700HD	4700	3000	3600	40

SHOCK ABSORBER HOOK

Lapin shock absorber hook is used for the transfer of electrode columns for off furnace assembly. Using Lapin shock absorber hook assists in negating the effects of shock loading that may occur on nipples and sockets when removing an electrode column from the EAF arm or from reserve stand.



Following standard models are available ;

Electrode Dia. (mm)	Order Nr.	Max. Cap. Kgs	A (mm)	B (mm)	C (mm)	D (mm)	E Dia. (mm)	Weight Kgs
250	SAH250	600	570	195	33	18	90	13
300	SAH300	850	580	195	33	18	90	14
350	SAH350	1100	600	200	42	18	100	16
400	SAH400	1600	640	205	42	20	100	18
450	SAH450	2300	680	220	55	22	100	25
500	SAH500	3000	740	240	55	25	110	32
550	SAH550	3800	770	260	55	25	120	35
600	SAH600	4500	850	270	60	30	120	52
650	SAH650	5500	900	285	60	30	140	58
700	SAH700	6500	950	285	60	35	140	65
750	SAH750	7800	1000	310	60	35	150	76
800	SAH800	9000	1000	340	60	35	150	80

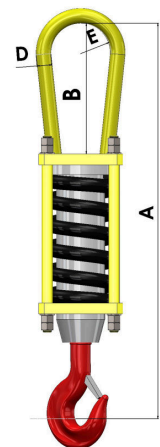

STEEL LIFTING PLUG

Lapin steel lifting plugs are developed for effective and safe electrode/electrode column transport at Meltshops. With high quality steel body and sharp tolerances Lapin steel lifting plugs have much more longer life time then the graphite lifting plugs.

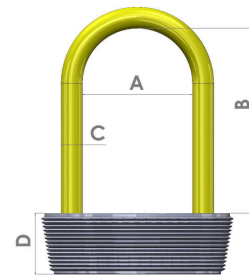

Electrode Dia. (mm)	Order Nr.	Nipple code	A (mm)	B (mm)	C (mm)	D (mm)	Weight Kgs
200	SLP200	122 T4	80	200	16	57	5
225	SLP225	139 T4	80	200	16	57	6
250	SLP250	152 T4	80	250	20	60	8
300	SLP300	177 T4	100	250	20	70	9
350	SLP350	203 T4	115	300	22	75	10
400	SLP400	222 T4	130	300	22	80	11
450	SLP450	241 T4	130	350	25	85	16
500	SLP500	269 T4	150	350	30	90	22
550	SLP550	298 T4	180	375	35	95	25
600	SLP600	317 T4	180	375	35	100	28
650	SLP650	355 T4	200	420	40	105	36
700	SLP700	374 T4	200	420	40	110	43
750	SLP750	406 T4	200	420	45	120	49
800	SLP800	431 T4	200	420	45	130	56

STEEL LIFTING PLUG

[COMPACT VERSION]

Lapin steel lifting plugs are developed for effective and safe electrode/electrode column transport at Meltshops. With high quality steel body and sharp tolerances Lapin steel lifting plugs have much more longer life time then the graphite lifting plugs.

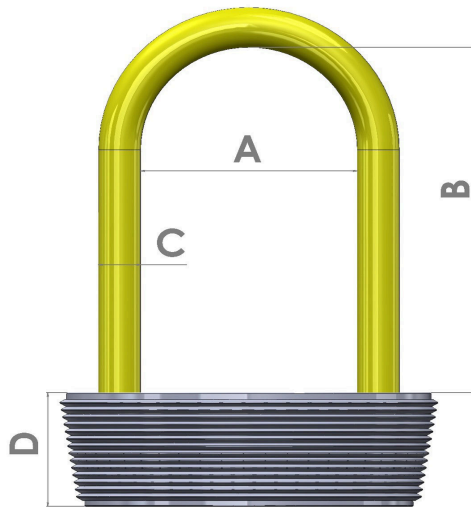

Electrode Dia. (mm)	Order Nr.	Nipple code	A (mm)	B (mm)	C (mm)	D (mm)	Weight Kgs
200	SLPC200	122 T4	80	120	16	57	3,5
225	SLPC225	139 T4	80	130	16	57	3,5
250	SLPC250	152 T4	80	200	20	60	4,5
300	SLPC300	177 T4	100	200	20	70	6
350	SLPC350	203 T4	110	200	22	75	8
400	SLPC400	222 T4	130	200	22	80	10,5
450	SLPC450	241 T4	130	200	25	85	13,5
500	SLPC500	269 T4	150	200	30	90	18
550	SLPC550	298 T4	180	210	35	95	24
600	SLPC600	317 T4	180	210	35	100	27
650	SLPC650	355 T4	200	220	40	105	39
700	SLPC700	374 T4	200	250	40	110	42
750	SLPC750	406 T4	200	250	45	120	49
800	SLPC800	431 T4	200	250	45	130	52

STEEL LIFTING PLUG

(LONG VERSION)

Lapin steel lifting plugs are developed for effective and safe electrode/electrode column transport at Meltshops. Long steel lifting plugs are designed for special transport needs of meltshops.

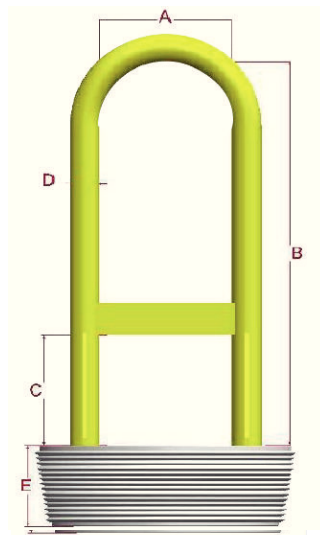

Electrode Dia. (mm)	Order Nr.	Nipple code	A (mm)	B (mm)	C (mm)	D (mm)	E (mm)	Weight Kgs
400	SLPL400	222 T4	130	400	140	25	80	13
450	SLPL450	241 T4	130	410	140	30	85	16
500	SLPL500	269 T4	140	450	180	30	90	22
550	SLPL550	298 T4	140	450	180	35	95	29
600	SLPL600	317 T4	150	460	180	35	100	33
650	SLPL650	355 T4	150	670	190	40	105	48
700	SLPL700	374 T4	170	780	200	40	110	53
750	SLPL750	406 T4	170	780	200	45	120	67
800	SLPL800	431 T4	180	780	200	45	130	70

GRAPHITE LIFTING PLUG (STEEL PART)

Lapin graphite nipple steel part are designed for usage of producers extra nipples.
Standard dimensions

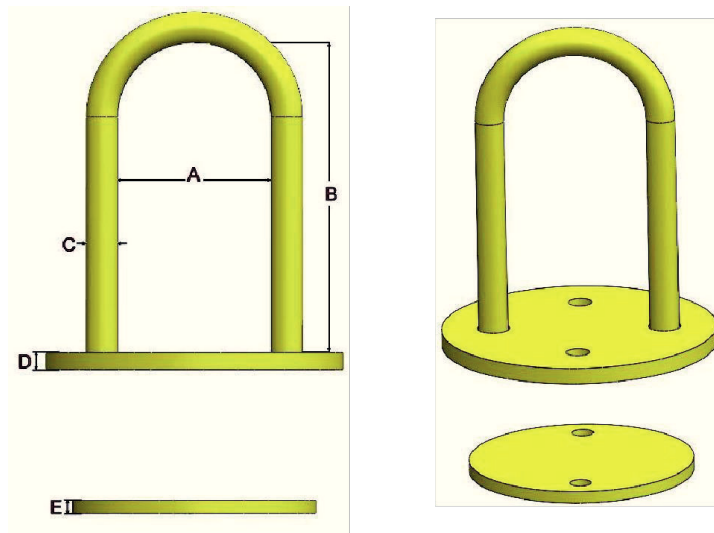

Standard models ;

Electrode Dia. (mm)	Order Nr.	Nipple code	A (mm)	B (mm)	C (mm)	D (mm)	E (mm)	Weight Kgs
400	SLP-SP400	222 T4	130	300	22	15	12	6
450	SLP-SP450	241 T4	130	350	25	15	12	11
500	SLP-SP500	269 T4	140	350	30	15	12	18
550	SLP-SP550	298 T4	140	375	35	20	15	22
600	SLP-SP600	317 T4	150	375	35	20	15	26
650	SLP-SP650	355 T4	150	420	40	20	15	37
700	SLP-SP700	374 T4	170	420	40	25	20	40
750	SLP-SP750	406 T4	170	420	45	25	20	40
800	SLP-SP800	431 T4	180	420	45	25	20	41

TRANSPORT RING

Lapin transport rings are produced for safe transport operations electrode/electrode column and nipples when required in special situations. With its high quality steel tooth structure, Lapin steel transport rings have a long service life.

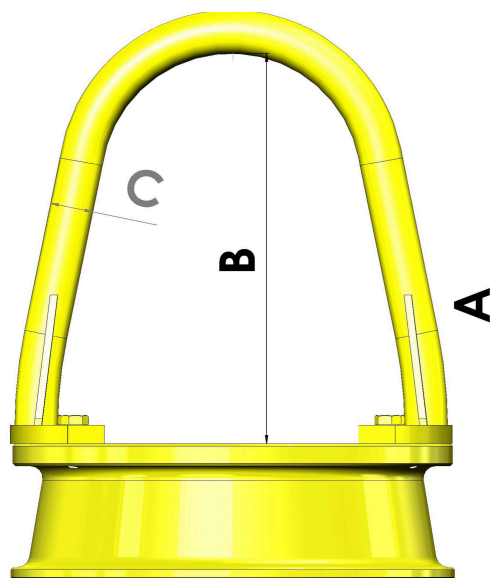

Electrode Dia. (mm)	Order Nr.	Max. Cap. Kgs	Nipple code	A (mm)	B (mm)	C (mm)	Weight Kgs
250	TR250	500	152 T4	330	250	20	6
300	TR300	650	177 T4	345	285	20	8
350	TR350	850	203 T4	385	290	22	11
400	TR400	1100	222 T4	415	310	25	10
450	TR450	1700	241 T4	425	310	30	18
500	TR500	2200	269 T4	440	340	30	19
550	TR550	2600	298 T4	480	370	35	25
600	TR600	3500	317 T4	500	400	35	30
650	TR650	4250	355 T4	550	440	35	36
700	TR700	5000	374 T4	550	460	40	43
750	TR750	6000	406 T4	590	480	40	50
800	TR800	7000	431 T4	590	500	40	58

RESCUE LIFTER

Lapin rescue lifter is one of the best way for fishing the broken electrode/electrode column during melting or refining. With built in high quality steel parts, Lapin rescue lifter is designed for working reliable at heavy conditions of Meltshops.



Electrode Dia. (mm)	Order Nr.	Max. Cap. Kgs	Weight Kgs
250	RL250	1250	80
300	RL300	1500	108
350	RL350	1800	130
400	RL400	2200	170
450	RL450	2500	218
500	RL500	2900	245
550	RL550	3400	300
600	RL600	4000	405
650	RL650	4750	500
700	RL700	5500	540
750	RL750	6250	695
800	RL800	7000	765

RESCUE TONG

Lapin rescue tongs have been developed for safely removing of electrode/electrode columns, especially vertically broken at EAF and LF. Lapin rescue tongs are produced in table given dimensions. Please contact us for special needs.

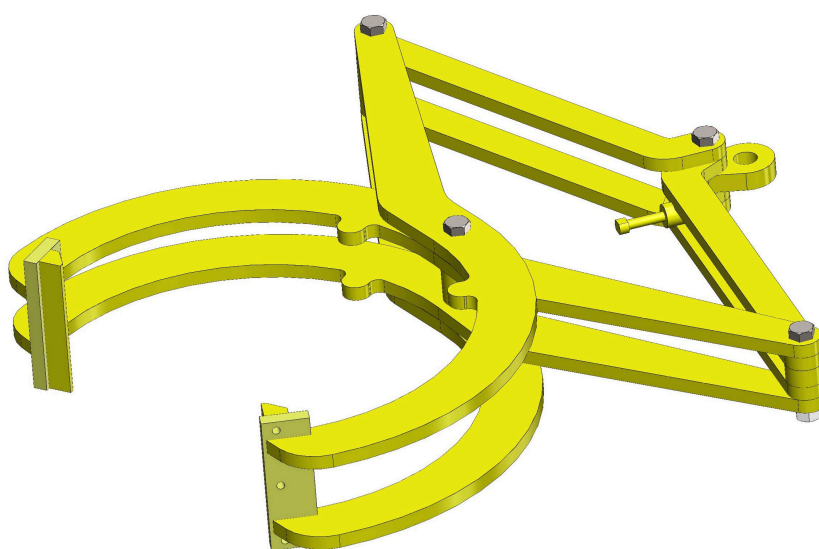

Electrode Dia. (mm)	Order Nr.	Max. Cap. Kgs	Weight Kgs
250	RT250	750	35
300	RT300	900	50
350	RT350	1200	68
400	RT400	1350	80
450	RT450	1500	100
500	RT500	1750	125
550	RT550	2050	155
600	RT600	2500	185
650	RT650	2900	220
700	RT700	3300	255
750	RT750	3750	295
800	RT800	4250	340

HYDRAULIC TIGHTENING STATION

Lapin hydraulic tightening station is the best possible way for safety and practical off furnace electrode tightening.

Unit comes with complete stand alone hydraulic system and built in lever clamber. With adjustable torque meter switch, the device can be used to handle different torque values of various electrode brands.

With compact and unique design Lapin hydraulic torque device brings certain solution for graphite handling problems.

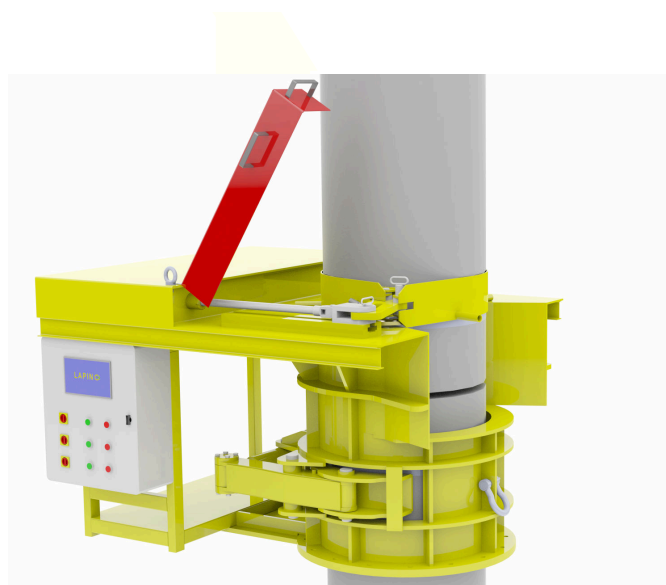

Electrode Dia. (mm)	Order Nr.	Tightening Torque Range Nm	Weight Kgs
400	HTD400	1000 - 2200	350
450	HTD450	1300 - 2700	410
500	HTD500	1700 - 3300	480
550	HTD550	2400 - 3900	550
600	HTD600	3400 - 4700	590
650	HTD650	4500 - 5700	630
700	HTD700	5700 - 7000	690
750	HTD750	7000 - 8400	730
800	HTD800	8500 - 10000	780

HYDRAULIC / PNEUMATIC CLAMPING COLLAR

Hydraulic/pneumatic clamping collars are the most wearing out part of the hydraulic/pneumatic electrode adding stations. It has a body with steel nails applied for non-slip.

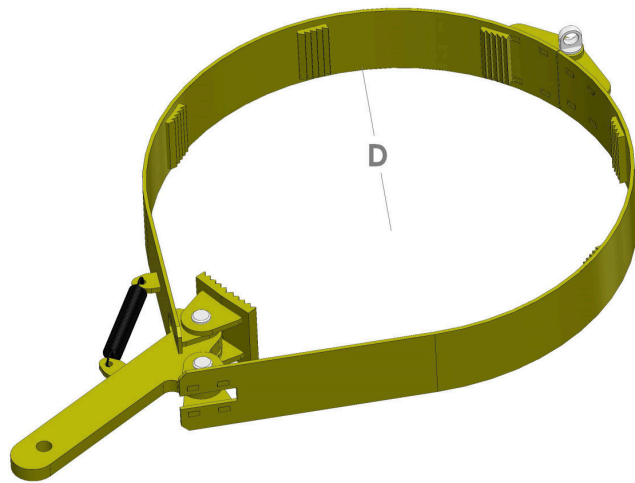

Following standard models are available ;

Electrode Dia. (mm)	Order Nr.	Tightening Torque Nm	B (mm)	C (mm)	L (mm)	Weight Kgs
400	LCC400	1650	15	20	510	13
450	LCC450	2750	15	20	525	14
500	LCC500	3400	20	25	580	15
550	LCC550	4400	20	25	610	16
600	LCC600	5100	20	30	630	17
650	LCC650	6100	25	30	700	20
700	LCC700	7900	25	30	725	23
750	LCC750	8300	25	35	750	26
800	LCC800	8600	25	35	750	30

RESERVE STAND

Lapin reserve stands are produced for safe storage of electrode/electrode columns on the platform area. Using reserve stands especially needed when hot electrode columns are taken from the EAF or LF and kept on stand for column change or furnace maintenance.

Hot electrode columns must be kept in air sealed stand tubes to prevent air circulation and side oxidation during on stand waiting time. Lapin reserve stands are produced with jaw-blocking lock system and they are integrated to Lapin hydraulic Station.

Electrode Dia. (mm)	Order Nr.	Weight Kgs
400	RS400	90
450	RS450	100
500	RS500	125
550	RS550	135
600	RS600	200
650	RS650	240
700	RS700	260
750	RS750	290
800	RS800	315

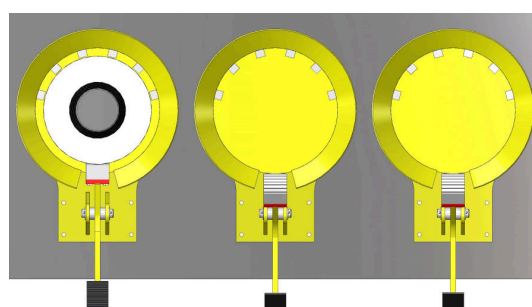
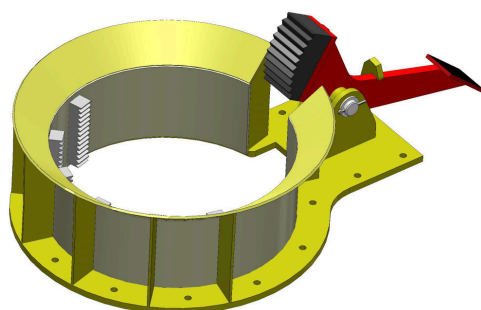
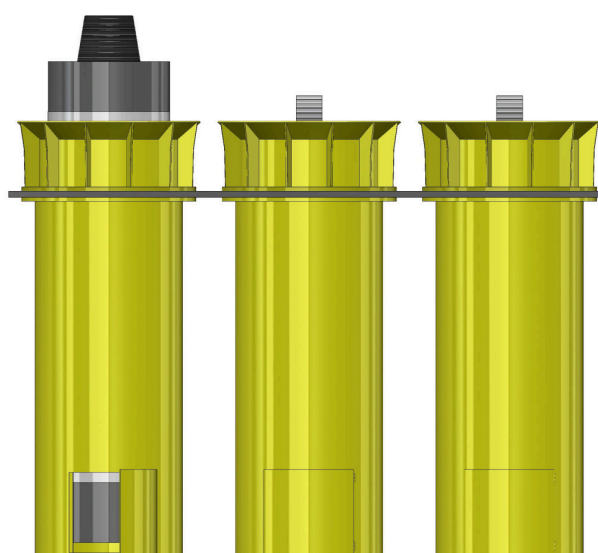

STAR WRENCH

(MANUEL CLAMPING COLLAR)

Lapin star wrenches are simply the best selection.

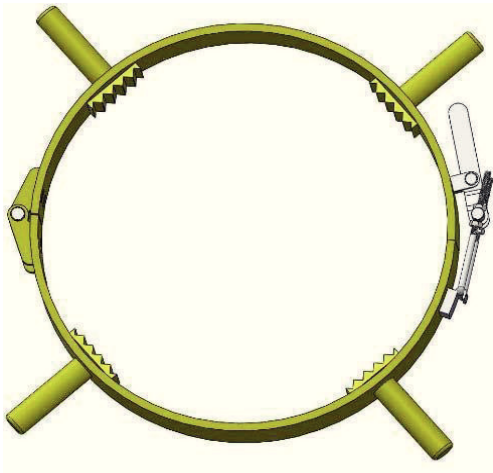

Electrode Dia. (mm)	Order Nr.	Weight Kgs
250	SW250	3
300	SW300	4
350	SW350	5
400	SW400	6
450	SW450	8
500	SW500	9
550	SW550	10
600	SW600	11
650	SW650	13
700	SW700	15
750	SW750	17
800	SW800	21

RECOVERY LIFT RING

This device is one of the best practical way for fishing broken electrode / electrode column especially at narrow positions.



Electrode Dia. (mm)	Order Nr.	Max. Cap. Kgs	Weight Kgs
250	RLR250	1500	13
300	RLR300	2000	18
350	RLR350	3250	24
400	RLR400	5000	34
450	RLR450	6500	40
500	RLR500	7500	52
550	RLR550	9000	61
600	RLR600	10000	69
650	RLR650	14000	78
700	RLR700	14000	89
750	RLR750	17000	96
800	RLR800	17000	102

NIPPLE REMOVAL TOOL

This device is the safe and practical way for unplugging the original or damaged preset nipples.



Electrode Dia. (mm)	Order Nr.	Weight Kgs
250	NRT250	6
300	NRT300	8
350	NRT350	9
400	NRT400	11
450	NRT450	13
500	NRT500	15
550	NRT550	18
600	NRT600	21
650	NRT650	24
700	NRT700	26
750	NRT750	28
800	NRT800	30

SPACER

Prevents thread damage to the electrode and nipple when the nipple is lowered into the socket. Also makes the alignment of the electrodes easier.

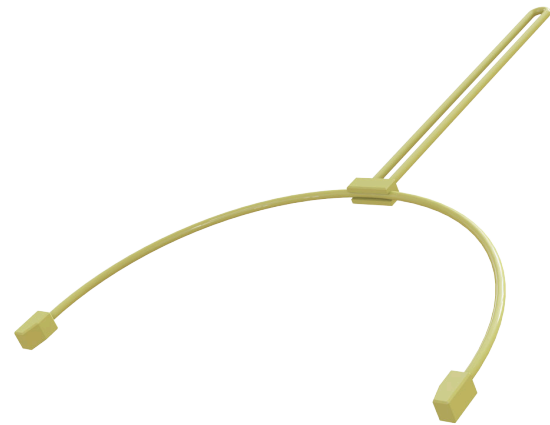

Electrode Dia. (mm)	Order Nr.	Weight Kgs
200-250	SPC100	1
250-350	SPC200	2
350-450	SPC300	2,5
450-550	SPC400	3
550-650	SPC500	3,5
650-800	SPC600	4

REFERENCES

GRAPHITE INDIA LTD	INDIA
HEG LTD	INDIA
UK CARBON & GRAPHITE COMPANY	ENGLAND
TATA STEEL	INDIA
VSC-POSCO STEEL CO.	VIETNAM
SAUDI IRON & STEEL CO.	SAUDI ARABIA
GPH ISPAT LIMITED	BANGLADESH
LAD TRADE	SWITZERLAND
KURUM INTERNATIONAL	ALBENIA
MOON IRON & STEEL COMPANY SOAC	OMAN
PROMETAL CM	CAMEROON
TOSCELİK ALGERIA	ALGERIA
THE SIAM IRON AND STEEL (2001) CO. LTD.	THAILAND
PASARGAD STEEL COMPLEX	IRAN
MASGLOBAL	IRAQ
HENDSTEEL	IRAQ
VANSTEEL	IRAQ
EZDK STEEL	EGYPT
İZMİR DEMİR ÇELİK	İZMİR / TURKEY
TOSÇELİK	ISKENDERUN / TURKEY
SİDDİK KARDEŞLER	KOCAELİ / TURKEY
EKİNCİLER DEMİRÇELİK	ISKENDERUN / TURKEY
KOÇ METALURJİ	OSMANIYE / TURKEY
MESCİER DEMİR ÇELİK	KARABUK / TURKEY
ÇEBİTAŞ	İZMİR / TURKEY
KAPTAN DEMİR ÇELİK	TEKİRDAĞ / TURKEY
MGG DEMİR ÇELİK	KOCAELİ / TURKEY
DİLER DEMİR ÇELİK A.Ş.	KOCAELİ / TURKEY
KAR-DEMİR	İZMİR / TURKEY



T.C.
TÜRK PATENT ENSTİTÜSÜ

MARKA TESCİL BELGESİ

Marka No : 2012 66603 - Hizmet

LAPING

Marka Sahibi : LAPIN DIŞ TİCARET SERACILIK İNŞAAT MAKİNA
SANAYİ VE TİCARET LİMİTED ŞİRKETİ
5. SAN. SİT. 7419/12 SK. NO: 114/A
35060 BORNOVA - İZMİR / TÜRKİYE
Emtiası : 35
İlişiktir.

Markaların Korunması Hakkında 556 Sayılı Kanun Hükmünde
Kararnameye göre 26/07/2012 tarihinden itibaren ON YIL müddetle
05/03/2014 tarihinde tescil edilmiştir.



Elif B. AKIN
Enstitü Başkanı
Markalar Dairesi Başkanı

TÜRK PATENT ENSTİTÜSÜ

Sertifika Certificate



LAPING

GRAPHITE ELECTRODE HANDLING DEVICES

LAPIN DIŞ TİCARET SERACILIK İNŞAAT MAKİNA
SANAYİ VE TİCARET LİMİTED ŞİRKETİ

KEMALPAŞA MAH. 74161 SK. NO: 83 A BORNOVA / İZMİR

DSR BELGELENDİRME tarafından denetlenmiş ve uygulamakta olduğu
Kalite Yönetim Sisteminin

is audited by DSR Certification and applied
Quality Management System meet the requirements of

ISO 9001:2015

standardına aşağıdaki kapsamda uyumakta olduğu gözlenmiştir.
standard for the following activities:

GRAFİT ELEKTROT EKLEME, TAŞIMA, KURTARMA APARATLARI ÜRETİM VE SERVİS İŞLERİ
PRODUCTION & SERVICE OF GRAPHITE ELECTRODE HANDLING DEVICES

Sertifika No / Certificate No: QMS-21.08.311

12.08.2021
Sertifika Tarihi
Certificate Date

12.08.2021
Sertifika Son Basım Tarihi
Certificate Last Issue Date

11.08.2022
Sertifika Geçerlilik Tarihi
Certificate Expiry Date

3 Yıl / Years
Belgeleme Periyodu
Certification Period

EA KODUEA 18
Code



DSR TEKNİK MUAYENE SERTİFİKASYON HİZ. LTD. ŞTİ.
Yeşilbağlar Mah. Seritli Sk. Hıltis Beyaz Otu 21 A Blok No:207 PENCİK / İSTANBUL / TÜRKİYE Tel: +90 216 666 66 35
Email: info@dergelendireme.com.tr - Web: www.dergelendireme.com.tr

Q



LAPIN DIŐ TİCARET SERACILIK İNŐAAT MAKİNA SANAYİ VE TİCARET LTD. ŐTİ.
5. San. Sit. 7419/12 Sk. No: 114/A 35060 Bornova - İZMİR / TÜRKİYE
info@lapintrade.com - +90 232 479 60 06
w w w . l a p i n . c o m . t r